

Tono B Multi with hex louver

Low Voltage Track Projectors | IP40 | Class III | Dimmable

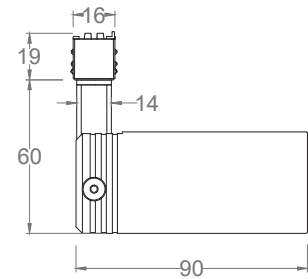
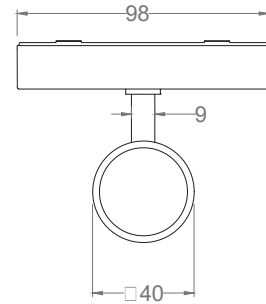

LIGHT SOURCE & OPTIC

Power

3W
7W
10W

Lens

3°/ 10°/ 30°/ 50°

Beam Direction

Adjustable:
Tilting +/- 90°, Rotating +/- 355°,
Symmetrical

Material

PMMA

LED quantity

1

Binning

2 MacAdam step

Color temperature & quality

2700K CRI>80
3000K CRI>80/95
3500K CRI>80
4000K CRI>80
5000K CRI>80

Lifetime

(L90) >60.500 hrs

FIXTURE

Dimensions

Ø 40mm x H 90mm (cylinder)

Material

Aluminium

Body finishes

White (RAL 9003)
Dark Bronze
Black (RAL 9005)

Weight

190gr

Mounting

On Track

Fixing

Track connector

Working temperature

-20° / +40°

ELECTRICAL FEATURES

Power supply

Constant tension 24-48 Vdc
Typical Vf= 3V (3W version)
Typical Vf= 12V

Driver

Remote (not included)

Control

On/off
DALI
Broadcast

Tono B Multi with hex louver

PHOTOMETRIC DATA (3000K CRI>80)

3W - 3° | UGR 6

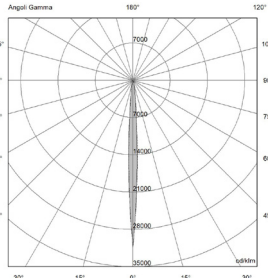

H (m)	D (m)	Eav (lx)
1	0.10	3157
2	0.21	789
3	0.31	351
4	0.41	197
5	0.52	126

Total lumen output
166 lm

Efficacy
55 lm/W

7W - 10° | UGR 8

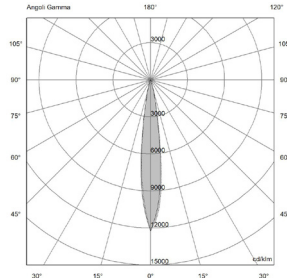

H (m)	D (m)	Eav (lx)
1	0.25	3181
2	0.51	795
3	0.76	353
4	1.01	199
5	1.27	127

Total lumen output
413 lm

Efficacy
59 lm/W

7W - 30° | UGR 11

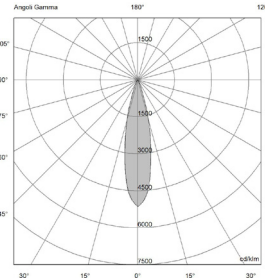

H (m)	D (m)	Eav (lx)
1	0.41	1111
2	0.82	278
3	1.23	123
4	1.64	69
5	2.05	44

Total lumen output
346 lm

Efficacy
49 lm/W

7W - 50° | UGR 13

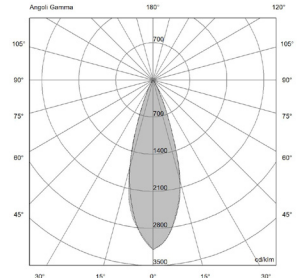

H (m)	D (m)	Eav (lx)
1	0.59	579
2	1.18	149
3	1.76	64
4	2.35	36
5	2.94	23

Total lumen output
249 lm

Efficacy
35 lm/W

10W - 10° | UGR 8

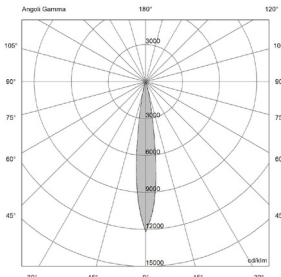

H (m)	D (m)	Eav (lx)
1	0.25	4108
2	0.51	1027
3	0.76	456
4	1.02	257
5	1.27	164

Total lumen output
535 lm

Efficacy
53 lm/W

10W - 30° | UGR 12

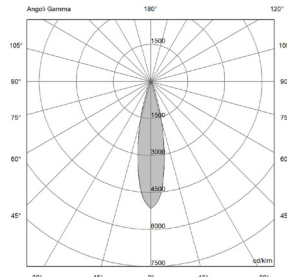

H (m)	D (m)	Eav (lx)
1	0.41	1438
2	0.82	359
3	1.24	160
4	1.65	90
5	2.06	58

Total lumen output
447 lm

Efficacy
45 lm/W

10W - 50° | UGR 14

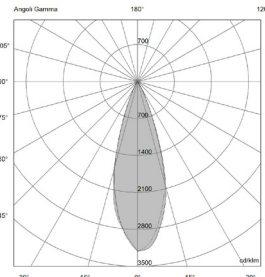

H (m)	D (m)	Eav (lx)
1	0.59	757
2	1.18	189
3	1.77	84
4	2.36	47
5	2.95	30

Total lumen output
389 lm

Efficacy
39 lm/W

Tono B Multi with hex louver

INSTALLATION ACCESSORIES

Compatible with 24-48Vdc Multi Track:

Surface installation (A01048._0)



Trimless installation (A01402._0)

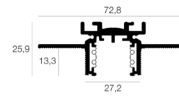
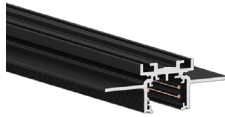

Suspended installation (A01351._0)



SUGGESTED REMOTE DRIVERS

On/Off :

CV70-F-24-N

CV150-F-48-N

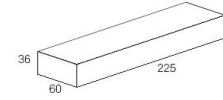

Ø 70

For On/Off and DALI version.
Please consider 1 address for each DALI projector.

Multifunction (DALI 2, 0/1-10V, PUSH):

CV75-DM-24-NI

CV75-DM-48-NI

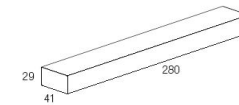

Ø 49

For Broadcast version.
Please consider 1 address for each driver in case of DALI control.

Other options upon request